

Colorway 1

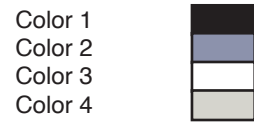

Colorway 2

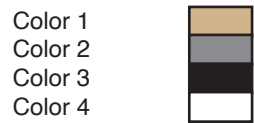

Outer Views

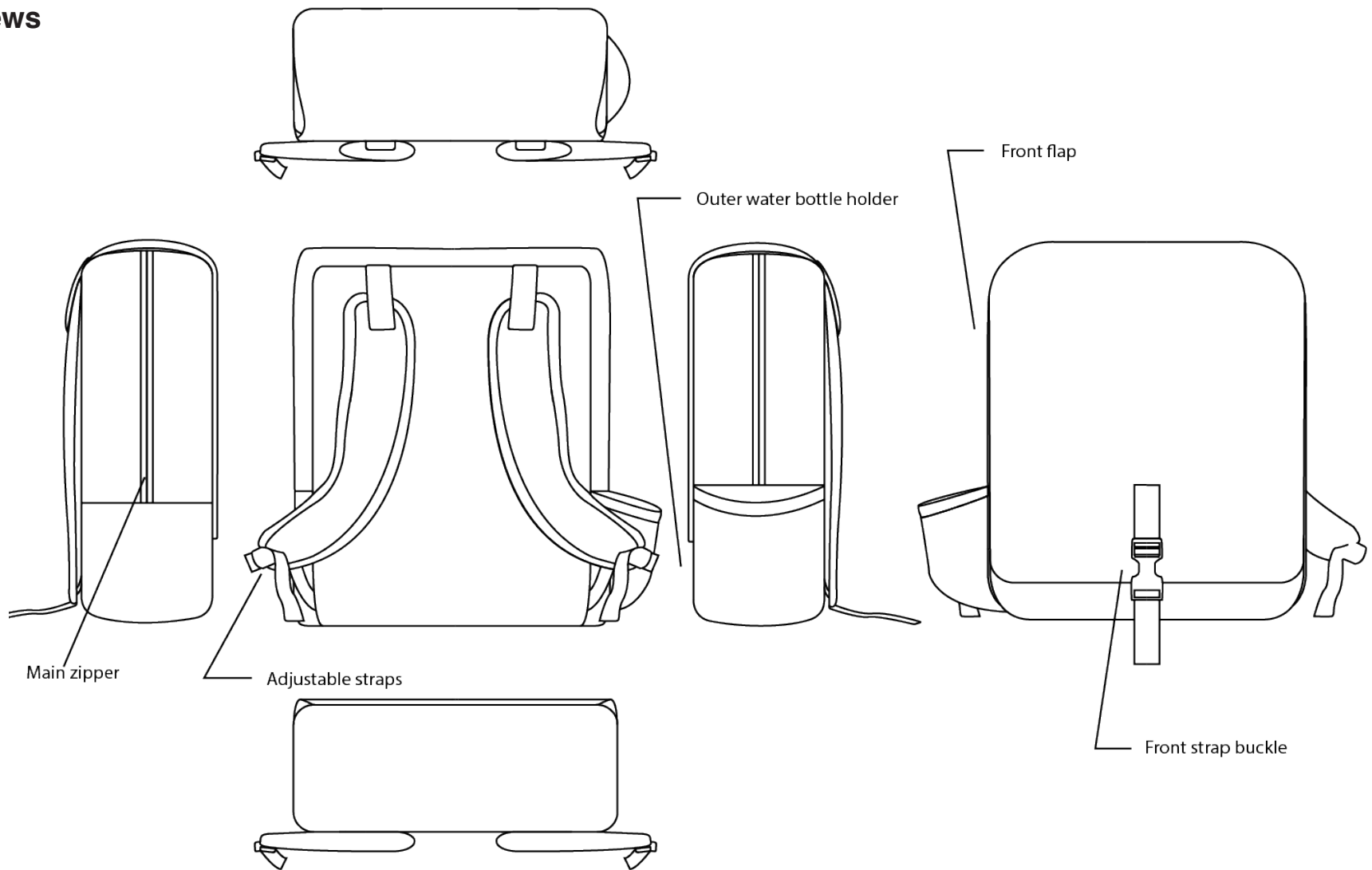

Interior Views

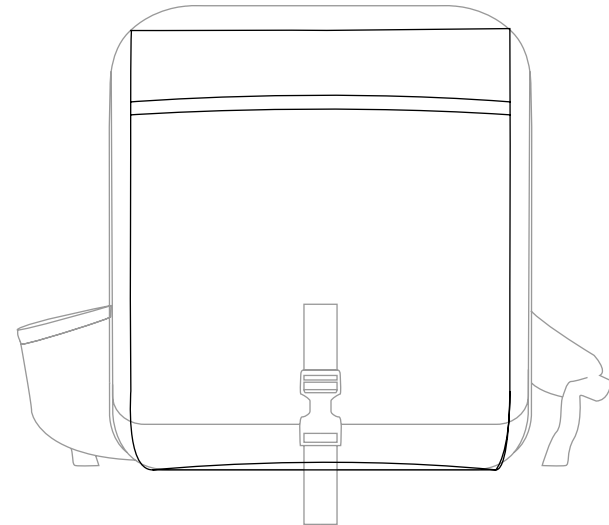
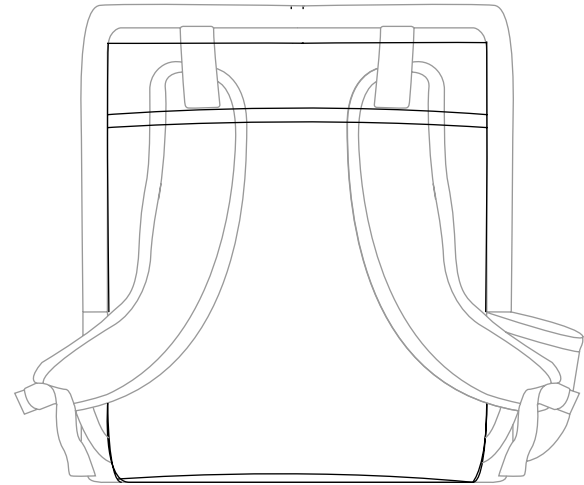
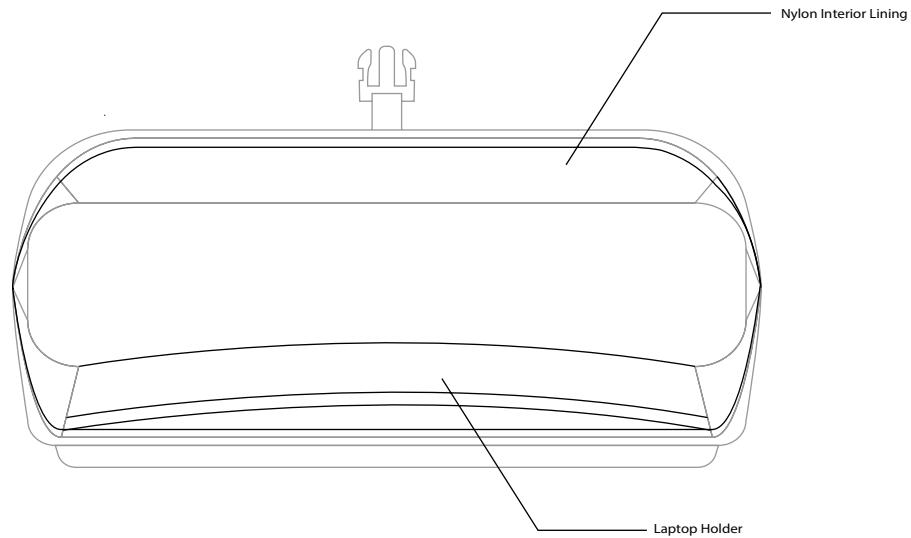

Bill of Materials

Item/Desc.	Content	Placement	Supplier	Width/Weight/Size	Finish	Qty
Cotton duck canvas	100% Cotton	Outer Shell	Michael's	60 inches	N/A	2.5 yards
Ripstop nylon	100% Nylon	Interior Lining	Fishman's Fabric	60 inches	PU Coated	1.75 yards
Open end zipper	Polyester, Nylon	Main zipper	Michael's	32 inches	Jet Black	1
1/2 Inch Double Fold Binding	80% Cotton 20% Polyester	Laptop and water bottle holder binding	Michael's	8 inches	N/A	.5 yards
Mesh Fabric	100% Polyester	Water bottle holder	Fishman's Fabric	8 inches	N/A	.5 yards
Nylon webbing	100% Nylon	Straps & flap buckle	Michael's	1 inch	N/A	48 inches
Quick release strap buckle	Acetal	Flap buckle	Amazon	1.25	N/A	1
EVA foam roll	Ethylene-vinyl Acetate	Structure & padding	Michael's	6mm thick	N/A	1
All purpose thread	100% Cotton	Outer shell, straps, lining, pockets	Michael's	N/A	Jet Black	2
Tri-glide strap slide	Acetal	Straps & flap buckle	Amazon	1.25 inches	N/A	2
Closed cell foam	Polyethalyne	Straps	Fishman's Fabric	.5 inches	N/A	2

Colorway Summary

Colorway	Outer Fabric	Lining Fabric	Hardware	Zippers	Thread
Obsidian	Jet Black	Cool Gray	Jet Black	Jet Black	Jet Black, White
Earthtone	Tan Brown	Smoke Gray	Jet Black	Jet Black	White, Smoke Gray

Measurements

Code	Measurement	Tol (+)	Tol (-)	Size
A	Total Width	.25 in	.25 in	13 in
B	Strap Top Webbing	.25 in	.25 in	3.25 in
C	Side Bottom Height	.25 in	.25 in	6.5 in
D	Water Bottle Binding Width	.25 in	.25 in	8.5 in
E	Total Width	.25 in	.25 in	8 in
F	Flap Width	.25 in	.25 in	12.5 in
G	Total Zipper Width	.25 in	.25 in	.75 in
H	Flap Width	.25 in	.25 in	14.5 in
I	Buckle Top Webbing	.25 in	.25 in	3.25 in
J	Buckle Bottom Webbing	.25 in	.25 in	4 in
K	Strap Bottom Webbing	.25 in	.25 in	15 in
L	Total Height	.25 in	.25 in	17.5 in
M	Buckle Height	.25 in	.25 in	1.75 in
N	Webbing Width	.25 in	.25 in	1 in

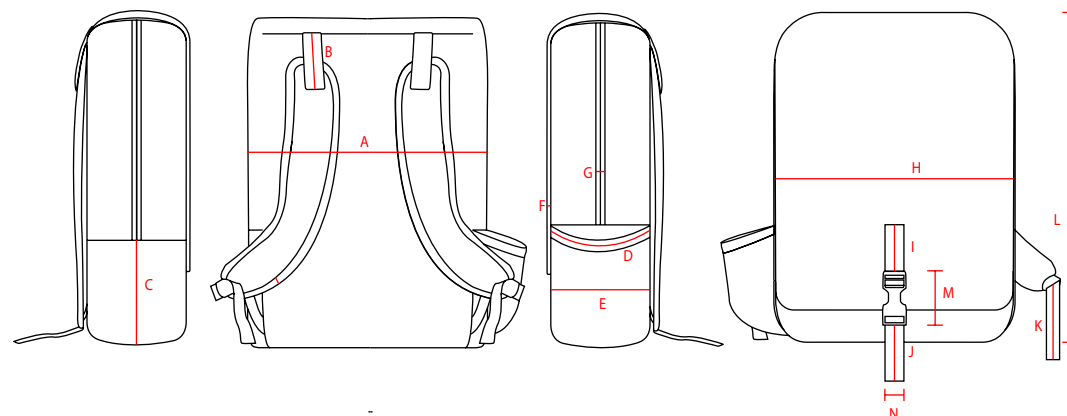

Construction Details

	Operation-Outer	Description	SPI	Seam Allowance	Special Instructions
A	Zipper	Sew together main side pieces to 1/4 inch from middle of zipper	8	1/2 inch for all unless otherwise stated	
B	Zipper bar tack	Bar tack zipper 1/2 from end			
C	Corner piece	Right sides together, sew top piece with zipper to bottom corner piece, don't sew over zipper on machine, hand sew over zipper	8		
D	Bottom buckle	Sew in bottom flap buckle to main front piece	8		
E	Main body front/back	Right sides together, line up non curved sides of main front piece and main back piece, sew	8		
F	Top buckle	Sew top flap buckle to front of one flap piece	8		
G	Flap	Right sides together line up flap 1 & 2, sew and leave hole	8		
H	Flap	Flip & hand sew opening shut, top stitch edges 1/4 inch	10		
I	Strap connecting	Line up strap ends to flap end fronts facing	8	1/4 inch	
J	Strap binding	Place binding to top of mesh fabric piece, sew 1/2 inch from edge	8		
K	Side connecting	Right sides together and with side pocket mesh sandwiched in between fabric on the bottom of the right side, line up bottom of main side piece to main front piece, sew starting from bottom corner all the way to the other side, leave rounded corners open	8		
L	Side connecting	Right sides together and with straps and flap sandwiched inside with proper placement, line up bottom of main side piece to main back piece, sew starting from bottom corner all the way to the other side, make sure to sew other side of mesh as well, leave rounded corners open	8		
M	Rounded corners	Hand sew rounded corners & bottom of both sides shut			
N	EVA foam	Line up EVA foam to sides and where the location of seam between main front and back, sew around foam	12		

	Operation-Straps	Description	SPI	Seam Allowance	Special Instructions
A	Strap body	Sandwich EVA foam in between spacer mesh piece and strap fabric piece, sew around 1/2 inch from edge	10		
B	Strap binding	Pin binding to edges all around the piece, sew 1/2 inch from edge	8		
C	Nylon webbing	Sew on nylon webbing straps to bottom and top & place on adjuster	10		

	Operation-Lining	Description	SPI	Seam Allowance	Special Instructions
A	Lining corner piece	Right sides together line up edge of main side pieces to bottom corner piece, sew	8	1/2 inch for all unless stated otherwise	
B	Lining main body front/back	Right sides together, line up non curved sides of main front piece and main back piece, sew	8		
C	Lining side connecting	Right sides together, line up bottom of main side/top piece to main front piece, sew starting from bottom corner all the way to the other side, leave rounded corners open	8		
D	Lining side connecting	Right sides together, line up bottom of main side/top piece to main back piece, sew starting from bottom corner all the way to the other side, leave rounded corners open	8		
E	Lining fold back	Fold 1/2 inch of top/side hard edge piece back, pin in place			
F	Lining connecting	Line up folded edge of lining to 1/6th inch from middle of zipper on inside of bag, sew	8	1/4 inch	

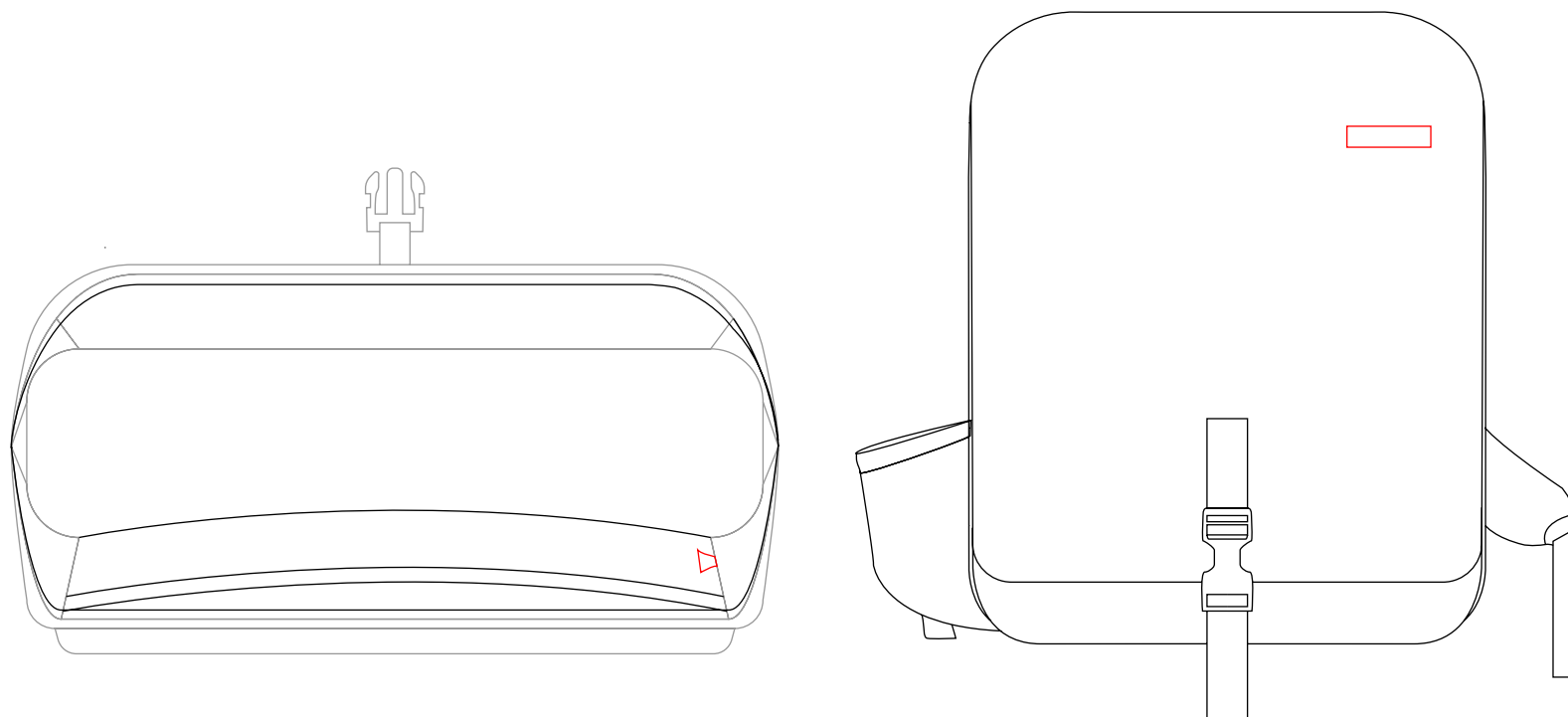
**Care Label Information**

Label Material: Woven Polyester
Label Size: 1.75" x 1.0"

Fiber Content: Cotton / Nylon / Polyester

Care Instructions: Spot clean only. Air dry.

Brand Label Information

Label Material: Matte TPU
Label Size: 2.0"x.5"

Construction Instructions: Heat-pressed or sewn perimeter stitch onto front panel. Tone-on-tone color matched to shell fabric.